

WORLD HEALTH ORGANIZATION
EMERGENCY MEDICAL TEAMS

2019 GLOBAL MEETING

12-14 JUNE 2019
BANGKOK, THAILAND

PROGRAMME



World Health
Organization



CONTENT

03

WELCOME MESSAGE

A quick welcome from WHO's Director General Dr Tedros and the Global EMT Initiatives Manager Dr Ian Norton

17

NAVIGATION

Where do I go?

Here you'll find a venue map to make sure you get to all your sessions on time!

05

PROGRAMME

What to expect

Here you will find the main agenda as well as a detailed guide on each session and what to expect

19

THANK YOU!

A message of thanks from WHO EMT Initiatives Dr Ian Norton to the EMT Community

EMT GLOBAL MEETING 2019



Welcome to the Emergency Medical Teams Global Meeting!
When a disaster strikes or an outbreak flares, the more rapid the response, the better the outcome for affected communities.

The EMT Initiative focuses on helping every country develop national teams, who can deploy where they are needed in the shortest possible time.

During this meeting, you will draw on your experiences and others to strengthen the core standards for EMTs in the second edition of the “Blue Book”. You will also consider the specific standards needed for EMTs operating in armed conflict, complex emergencies and outbreaks.

Thank you for your commitment to keeping the world safe. I wish you fruitful discussions and look forward to the concrete actions you will take to improve the quality of patient care in emergencies

Dr Tedros Adhanom Ghebreyesus
Director General
World Health Organization



AGENDA

EMT Global Meeting, 12-14 June 2019, Bangkok, Thailand																			
Timing	Tuesday, 11 June	Wednesday, 12 June						Thursday, 13 June						Friday, 14 June					
		R1/R2	R3	R4	R5	R6/R7	Pompadour	R1/R2	R3	R4	R5	R6/R7	Pompadour	R1/R2	R3	R4	R5	R6/R7	Pompadour
07:30	All day: arrival of participants & registration							Bilateral Meetings						Bilateral Meetings					
08:00		Registration						Registration						Registration					
08:30																			
09:00		Plenary opening: Welcome, key note & main global updates, official photo						Continuity of care in emergencies русский	Red Book: Peer Review Group - Members Only	Type 1 Mobile: Special Considerations	Logistics: Field Hospital Design Fuel and Power 中文	Emergency Operation Centres & National Coordination for EMTs	Clinical Care in Outbreaks: Role of EMTs in outbreaks, Field Operations Français	Mentorship and Classification; Introduction and lessons from EMTs русский			Minimum Data Set and Information management 中文	Safety and Security: What do EMTs need to know? Blue & Red Books Español	Community Engagement and Public Health in disasters and outbreaks
09:30																			
10:00		Coffee Break						Coffee Break						Coffee Break					
10:30		Europe русский	South East Asia	Eastern Mediterranean	Africa Français	Americas Español	Western Pacific 中文	Red Book: IHL and Core Humanitarian Principles in Action русский	Small Island Nation EMTs: Shared lessons across regions	Reproductive, maternal, newborn and child health	Surgical Specialist Teams 中文	International Coordination Mechanism for EMT, interactions with National EDCs and Regional Perspective	Design of Outbreak Treatment Centres: Ebola, respiratory, DTCs/CTCs Français	Type 2 & 3 Special Session: How to set-up a deployable Field Facility русский	EMT Nursing special interest group	Red Book: Medical Team Roles in Armed Conflict 中文	National EMT Accreditation; Adaption of global standards to national quality systems Español	Training for EMTs Français	
11:00																			
11:30																			
12:00																			
12:30		Lunch	Lunch/Bilateral Meetings/Poster Presentations						Lunch/Bilateral Meetings/Poster Presentations						Lunch/Bilateral Meetings/Poster Presentations				
13:00																			
13:30	10th EMT SAG meeting	Europe русский	South East Asia	Eastern Mediterranean	Africa Français	Americas Español	Western Pacific 中文	Red Book: Protection and gender-based violence 中文		Burns Care	Coordination in Outbreaks Français	WASH, Waste Management and Vector Control Español	Simulation and Exercises for EMTs русский	Europe русский	South East Asia	Eastern Mediterranean	Africa Français	Americas Español	Western Pacific 中文
14:00		Coffee break						Coffee break						Coffee break					
14:30	Break	Europe русский	South East Asia	Eastern Mediterranean	Africa Français	Americas Español	Western Pacific 中文	Lessons from recent deployments 中文		Pharmacy laboratory and radiology	Red Book: Coordination in Conflict Français	Triage, Mass Casualty and Pre-Hospital Management Español	Outbreaks: Standard of clinical Care русский	Plenary closing					
15:00																			
15:30	10th EMT SAG meeting	Mentor and Bilateral Meetings						Mentor and Bilateral Meetings											
16:00																			
16:30																			
17:00																			
17:30	Welcome reception	Host reception						Dinner (own arrangements)						Dinner (own arrangements)					
18:00																			
18:30																			
19:00																			
19:30																			

Colour-coding focus	
	Clinical
	Red Book (armed conflict and complex)
	Logistics
	Outbreaks
	Coordination and administration
	Training and mentorship
	Small Island Nations EMTs
	African Regional Group
	Americas Regional Group
	Eastern Mediterranean Regional Group
	European Regional Group
	South East Asia Regional Group
	Western Pacific Regional Group





DAY ONE

REGIONAL SESSIONS

All member state/National EMTs are kindly requested to attend their regional meeting (corresponding to WHO regional boundaries). EMTs are encouraged to attend the Regional meetings relevant to either their region of origin or region of most likely deployment (if different, then chose the region of likely deployment, or spread representatives in several regional meetings). Translation will be available as follows; AFRO: French, EURO: Russian, PAHO: Spanish, WPRO: Chinese.

Regional meetings will allow specific discussions to occur on areas such as regional implementation, joint trainings and exercises, Governance and Regional group next meetings etc. Recent responses and regional coordination methodology will be discussed. In the final regional sessions (Friday 14-15:30) Regional groups will discuss outcomes of the 3-day meeting, next steps and prepare brief statements to share with other regions in the plenary closing session.

DAY ONE

REGIONAL SESSIONS



TIME: 9:00 AM-5:30 PM
ROOM: RIVERSIDE V
TRANSLATION: FRENCH



TIME: 9:00 AM-5:30 PM
ROOM: RIVERSIDE VI/VII
TRANSLATION: SPANISH



TIME: 9:00 AM-5:30 PM
ROOM: RIVERSIDE I/II
TRANSLATION: RUSSIAN



TIME: 9:00 AM-5:30 PM
ROOM: RIVERSIDE IV
TRANSLATION: NONE



TIME: 9:00 AM-5:30 PM
ROOM: RIVERSIDE III
TRANSLATION: NONE



TIME: 9:00 AM-5:30 PM
ROOM: POMPADOUR
TRANSLATION: CHINESE

DAY TWO

CONTINUITY OF CARE IN EMERGENCIES

TIME: 9:00 AM-10:30 AM
ROOM: RIVERSIDE I/II
TRANSLATION: RUSSIAN

While emergency medical teams (EMTs) bring acute relief, many patients require ongoing medical and rehabilitative care for months or years beyond discharge. This session will examine the barriers to continuity of care faced in different emergency contexts, including outbreak, sudden-onset disaster and conflict, and the actions needed to address them. Case studies will be presented from Bangladesh, Mozambique, Syria and Nepal, and key issues will be discussed by an expert panel.

TYPE 1 MOBILE: SPECIAL CONSIDERATIONS

TIME: 9:00 AM-10:30 AM
ROOM: RIVERSIDE IV
TRANSLATION: NONE

While early discussions on EMT concentrated on large fixed facilities, the use of Mobile Type 1 teams in response to Typhoon Haiyan and the Nepal EQ justified the need for a distinct Type of EMT. Arguably even more complex to manage than a Type 1 Fixed team several Organizations and Countries will share their experience in running mobile operations in recent responses and discuss challenges and solutions; remote islands after Cyclones, accessing communities in floods, or developing rapid response national teams.

LOGISTICS: FIELD HOSPITAL DESIGN FUEL AND POWER

TIME: 9:00 AM-10:30 AM
ROOM: RIVERSIDE V
TRANSLATION: CHINESE

This is the first of several Logistics and Operational Support sessions and will discuss the experiences of teams with various field facility designs, the pros and cons of different set-ups in terms of weight, speed, operational constraints and cost. Heavy logistics supplies such as Fuel, power and transport of goods will be discussed, and lessons shared.

DAY TWO

EMERGENCY OPERATION CENTRES & NATIONAL COORDINATION FOR EMTs

TIME: 9:00 AM-10:30 AM
ROOM: RIVERSIDE VI/VII
TRANSLATION: SPANISH

The first of a full day series on coordination, we start with a session on national Health Emergency Operations Centers, hearing from three countries on how they have set up their Health EOC and placed national (and if required International) EMT Coordination within their normal Health Emergency Operations Response. This is a vital session to underpin the clinical response under coordination by host Ministries and showcase WHO's work to support localization of coordination by National Governments for Health Emergencies.

CLINICAL CARE IN OUTBREAKS: ROLE OF EMTs IN OUTBREAKS, FIELD OPERATIONS

TIME: 9:00 AM-10:30 AM
ROOM: POMPADOUR
TRANSLATION: FRENCH

Commencing a full day series on Outbreak response, we introduce the concept of management of both communicable disease presentations at regular EMTs (eg malaria, diarrhoea, Respiratory tract infections presenting at regular EMTs in disaster zones) and the concept of EMTs deploying to support clinical care in suspected and confirmed outbreaks (eg Cholera, Diphtheria, Ebola and Flu etc).

RED BOOK: IHL AND CORE HUMANITARIAN PRINCIPLES IN ACTION

TIME: 11:00 AM-12:30 PM
ROOM: RIVERSIDE I/II
TRANSLATION: RUSSIAN

The first of our open sessions regarding the new "Red Book" guidance on medical team response in conflict and complex emergencies. (Note the first morning session is for writing group members only). The session will introduce concepts of International Humanitarian Law and Principled action, with a focus on case studies and open discussions on practical solutions to this complex area. At all times the Red Book discussions will be open to all sides, and we encourage countries, militaries, NGOs, private providers and international organizations to contribute to this important discussion.



DAY TWO

SMALL ISLAND NATION EMTS; SHARED LESSONS ACROSS REGIONS

TIME: 11:00 AM-12:30 PM
ROOM: RIVERSIDE III
TRANSLATION: NONE

A very special session, open to all, but particularly relevant to representatives from island nations states from across the world who share similar risks from climate change, worsening storms, remote islands far from capital cities, and limited workforce and budgets. You can potentially have outbreaks and disasters that can affect half or more of your entire population. You are developing your own national EMTs, because who better to know your own country and respond fast, and you are all sovereign states who deserve to retain national leadership of your own response even when you choose to invite neighbours to support. Share experiences and discuss lessons and solutions with your fellow island nation colleagues from the Pacific, Caribbean, Indian Ocean and beyond.

REPRODUCTIVE, MATERNAL, NEWBORN AND CHILD HEALTH

TIME: 11:00 AM-12:30 PM
ROOM: RIVERSIDE IV
TRANSLATION: NONE

The working group have now finalized the “Minimum Standards and Recommendations for Reproductive, Maternal, Newborn and Child Health Care’ for Emergency Medical Teams”. Come along to hear updates from the working group, practical lessons from teams developing specialist teams for reproductive, maternal, neonatal and or child health care.

SURGICAL SPECIALIST TEAMS

TIME: 11:00 AM-12:30 PM
ROOM: RIVERSIDE V
TRANSLATION: CHINESE

Over 23 Specialist Team types exist, but the specialist surgical group of teams are arguably the most common, and most used. This session will discuss recommendations on what standards will be published in the new Blue Book on surgical specialist teams, including their logistics supply requirements, team make-up and share good examples of how to integrate such teams into a wider health response.

DAY TWO

INTERNATIONAL COORDINATION MECHANISMS FOR EMT, INTERACTIONS WITH NATIONAL EOC'S AND REGIONAL PERSPECTIVE

TIME: 11:00 AM-12:30 PM
ROOM: RIVERSIDE VI/VII
TRANSLATION: SPANISH

Continuing the coordination theme, this session will examine the regional coordination mechanisms used in the Americas and in SE Asia as well as by UN OCHA and introduce the perspective of a national EOC interacting with these international mechanisms. How do different regions support medical response and how will EMTs still be coordinated at national level, but with added value from regional coordination mechanisms.

DESIGN OF OUTBREAK TREATMENT CENTRES: EBOLA, RESPIRATORY, DTCS/CTCS

TIME: 11:00 AM-12:30 PM
ROOM: POMPADOUR
TRANSLATION: FRENCH

This is a combined outbreak and logistics session, bringing together both themes to address the challenges of designing and running effective treatment centers for outbreaks of diarrhoeal diseases (eg Cholera), Viral Haemorrhagic Fever (Ebola etc), Vector Borne and Respiratory outbreaks. A practical session with teams experienced in outbreak response sharing their ideas. We encourage all those teams considering this form of response to attend.

RED BOOK: PROTECTION AND GENDER-BASED VIOLENCE

TIME: 2:00 PM-3:30 PM
ROOM: RIVERSIDE I/II
TRANSLATION: CHINESE

The red book will have as a major section the issues of protection and prevention and care for victims of gender-based violence. This session will discuss practical steps that EMTs working in complex responses need to put in place, and share best practice for addition to the upcoming new guidance.



DAY TWO

BURNS CARE

TIME: 2:00 PM-3:30 PM
ROOM: RIVERSIDE IV
TRANSLATION: NONE

Every country is at risk of a major Burns event that will overwhelm their over-stretched Burns clinical care system. The Burns Working Group have met for the third time and are now ready to share outcomes and recommendations to national and international teams that will face Burns Mass casualties. The results may initially challenge your thinking; including where to send response teams, how much care to give on scene including restriction of fluids, and the complex area of burns severity estimation, triage and palliative care.

COORDINATION IN OUTBREAKS

TIME: 2:00 PM-3:30 PM
ROOM: RIVERSIDE V
TRANSLATION: FRENCH

This session will discuss the coordination models available (National Health EOC, Public Health EOC, Cluster approach etc) that have been used in recent responses to outbreak with examples including Nigeria, DRC, Bangladesh and others

WASH, WASTE MANAGEMENT AND VECTOR CONTROL

TIME: 2:00 PM-3:30 PM
ROOM: RIVERSIDE VI/VII
TRANSLATION: SPANISH

The Logistics and operations support experts reconvene to share challenges and solutions to the critical areas of Water, Sanitation, Waste Management and vector control. Come along and learn the latest on how to manage this vital area of your operations from the experts.

DAY TWO

SIMULATION AND EXERCISES FOR EMTs

TIME: 2:00 PM-3:30 PM
ROOM: POMPADOUR
TRANSLATION: RUSSIAN

This session will highlight the range of simulations at local/national, regional and inter-regional level available to EMTs. If you aren't on the panel and presenting feel free to come and speak from the floor about other initiatives in simulations and exercises you have developed in your organization. Most importantly what can WHO, regions and the EMT community do better in terms of simulations and exercises to improve response and impact.

LESSONS FROM RECENT DEPLOYMENTS

TIME: 4:00 PM-5:30 PM
ROOM: RIVERSIDE I/II
TRANSLATION: CHINESE

While recent responses will be highlighted and used as examples throughout our three-day meeting in every session, this session is dedicated to specific presentations from teams involved in responses such as Mozambique, the Rohingya crisis etc. Come and share your experiences from the floor if you were involved in these events or many others.

PHARMACY LABORATORY AND RADIOLOGY

TIME: 4:00 PM-5:30 PM
ROOM: RIVERSIDE IV
TRANSLATION: NONE

Allied Health, particularly Pharmacy, Radiology and Laboratory services are vital to the functioning of EMTs yet challenging to maintain minimum standards. What methods do we have to retain cold chain, should we adapt our formulations for paediatric suspensions, what medication storage conditions are adequate when deployed? What other challenges have you faced with pharmacy? How useful is Ultrasound and can it eventually replace X-Ray, or do we need both in EMTs? What are EMTs experiences with point of care testing and laboratory services and blood transfusion management? Come and discuss with peers and experts, we are sure someone in the room will have the answer to your questions!

DAY TWO

RED BOOK: COORDINATION IN CONFLICT

TIME: 2:00 PM-3:30 PM
ROOM: RIVERSIDE V
TRANSLATION: FRENCH

The last but probably most complex of all coordination sessions today, what methodologies should we use from national EOC and regional coordination structures, and which will need to be adapted, or placed in a neutral and purely Humanitarian space? How do we adapt other EMT methodologies such as Quality assurance visits etc during conflict? Open to all, we encourage those wishing to support positive and open progress on these issues to attend and contribute to the conversation.

TRIAGE, MASS CASUALTY AND PRE- HOSPITAL MANAGEMENT

TIME: 4:00 PM-5:30 PM
ROOM: RIVERSIDE VI/VII
TRANSLATION: SPANISH

National EMTs serve a vital role as part of the national response plans to a variety of hazards, including trauma care. Where do the concepts of pre-hospital, emergency medicine and EMT intersect or are they a continuum? What lessons can be shared by teams from recent mass casualty responses particularly in conflict, what can we learn from Trauma stabilization points, and what happens when your pre-hospital system is overwhelmed forcing casualties to wait on scene for days.

OUTBREAKS: STANDARD OF CLINICAL CARE

TIME: 4:00 PM-5:30 PM
ROOM: POMPADOUR
TRANSLATION: RUSSIAN

Clinical standards of care, the use of therapeutics, ethics and research on new therapeutics and EMTs approach to this area are complex. We will explore the challenge of a purely Public Health approach to "isolation" as an intervention, balanced with a message of treatment, hope and survival to individuals and their families, encouraging the community to present with the disease. Lessons not just from Ebola, but also Diphtheria, Cholera etc will be discussed.



DAY THREE

MENTORSHIP AND CLASSIFICATION: INTRODUCTION AND LESSONS FROM EMTs

TIME: 9:00 AM-10:30 AM
ROOM: RIVERSIDE I/II
TRANSLATION: RUSSIAN

A must for any EMT wishing to take part in the international mentorship and classification process. This session will outline how the system works, and share open feed-back, lessons and challenges from teams who are in the process or have recently completed it.

MINIMUM DATA SET AND INFORMATION MANAGEMENT

TIME: 9:00 AM-10:30 AM
ROOM: RIVERSIDE V
TRANSLATION: CHINESE

With strong examples of the recent Mozambique experience, this session will discuss the management of information, data sharing, patient records and the use of the “Minimum Data Set” (MDS) by EMTs in support of the national health response.

Come and contribute to the finalization of recommendations for the next version of the Blue Book regarding information management and reporting, as well as understand how to adapt and use the MDS and patient records for your own team.

SAFETY AND SECURITY: WHAT DO EMTs NEED TO KNOW? BLUE & RED BOOKS

TIME: 9:00 AM-10:30 AM
ROOM: RIVERSIDE VI/VII
TRANSLATION: SPANISH

Want to know the minimum Duty of Care standards applicable to the safety and security of EMTs? How do you develop effective security risk management (SRM) system in order to access affected communities, and deliver medical assistance? This session will hear from several different types of organizations on how they deal with these issues and become operational in disaster, outbreak and conflict scenarios. The session will also reflect upon some prominent security challenges and dilemmas for EMTs in the field, including issues related to risk transference to local counterparts, use of armed protection, crisis management and operational continuity.

DAY THREE

COMMUNITY ENGAGEMENT AND PUBLIC HEALTH IN EMERGENCIES

TIME: 9:00 AM-10:30 AM
ROOM: POMPADOUR
TRANSLATION: FRENCH

This session highlights the critical role that both national and international EMTs play, when directly engaging with affected communities during a humanitarian response. Case studies will be presented to highlight and share the different experiences of teams in the field who have worked in outbreaks, such as Ebola in the African Region and Diphtheria in Cox's Bazar, natural disasters, such as the recent Mozambique response, and in conflict such as the Gaza Strip.

TYPE 2 & 3 SPECIAL SESSION: HOW TO SET-UP A DEPLOYABLE FIELD FACILITY

TIME: 11:00 AM-12:30 PM
ROOM: RIVERSIDE I/II
TRANSLATION: RUSSIAN

Hear from experts and discuss with colleagues the challenges and potential solutions to creating an organization capable of deploying a full Type 2 or Type 3 field facility. How have teams managed procurement, storage, deployment of tents, even hundreds of tons, how do you limit wastage and stock spoilage if you don't deploy and when you do?

EMT NURSING SPECIAL INTEREST GROUP

TIME: 11:00 AM-12:30 PM
ROOM: RIVERSIDE IV
TRANSLATION: NONE

Nurses form over half of every EMT and fulfil critical roles and functions within the team and in team leadership. We are very pleased to announce a special interest group to encourage the EMT nursing community to share best practice and have a stronger voice in organizational design and management of EMTs. We encourage all nurses at the meeting to attend, but the session is open to all, and we would also encourage representatives from EMTs without strong nursing input to come and discuss ways to more actively engage nurses. The world's largest and most professional MoH and NGO EMTs all rely on exceptional nurses to function in preparedness and especially in response.

DAY THREE

RED BOOK: MEDICAL TEAM ROLES IN ARMED CONFLICT

TIME: 11:00 AM-12:30 PM
ROOM: RIVERSIDE V
TRANSLATION: CHINESE

The needs are greatest, yet the actors are few. The last of the red book sessions and a chance to bring together multiple discussions and use practical case examples of recent medical team deployments to chart a way forward for the red book guidance, and our future work to serve the most vulnerable, caught up in conflict and complex emergencies.

NATIONAL EMT ACCREDITATION: ADAPTION OF GLOBAL STANDARDS TO NATIONAL QUALITY SYSTEMS

TIME: 11:00 AM-12:30 PM
ROOM: RIVERSIDE VI/VII
TRANSLATION: SPANISH

As national EMTs strengthen a national accreditation working group has been formed to adapt and/or adopt the international mentor and classification system to improve quality of national Governmental and Non-Governmental EMTs. The first working group met in Indonesia in May. This work as well as lessons from several countries will be shared. Countries considering national EMTs will be interested in attending this session.

TRAINING FOR EMTS

TIME: 11:00 AM-12:30 PM
ROOM: POMPADOUR
TRANSLATION: NONE

This session will introduce you to a wealth of resources available to your EMT to either adapt, or partner with training available across your region. Teams will share experience of various models from in house delivery to out-sourcing, but at all times remaining consistent with the outcomes of the EMT training working group and needs of teams and team members deployed to difficult situations to deliver medical care.

DAY THREE

REGIONAL SESSIONS



TIME: 2:00 PM-3:30 PM
ROOM: RIVERSIDE V
TRANSLATION: FRENCH



TIME: 2:00 PM-3:30 PM
ROOM: RIVERSIDE VI/VII
TRANSLATION: SPANISH



TIME: 2:00 PM-3:30 PM
ROOM: RIVERSIDE I/II
TRANSLATION: RUSSIAN



TIME: 2:00 PM-3:30 PM
ROOM: RIVERSIDE IV
TRANSLATION: NONE



TIME: 2:00 PM-3:30 PM
ROOM: RIVERSIDE III
TRANSLATION: NONE



TIME: 2:00 PM-3:30 PM
ROOM: POMPADOUR
TRANSLATION: CHINESE



NAVIGATION

SECOND FLOOR

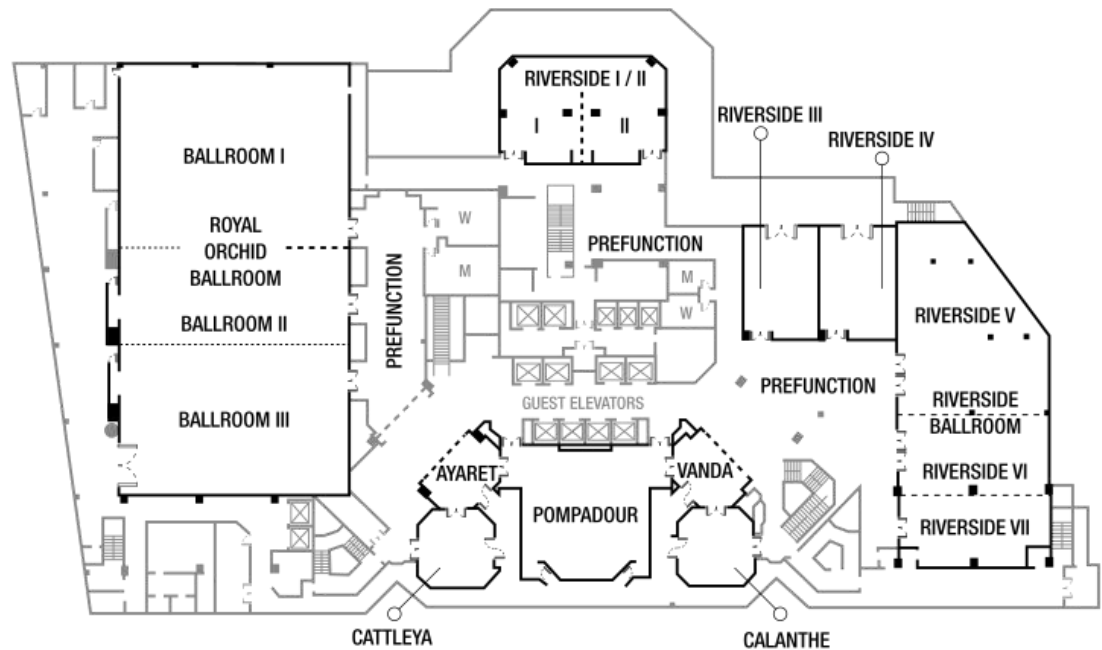

EMT GLOBAL MEETING 2019

Thank you for joining us in Bangkok for the third Emergency Medical Teams Global Meeting! I would like to begin by acknowledging the incredible work of the EMT community in emergency response—the risks you expose yourselves to, and the sacrifices you make to ensure affected communities receive the best possible care in times of need.

With the ever changing landscape of emergency response, we cannot afford to rest on the good work we have done together, which makes this meeting vital to driving further improvements in emergency preparedness and response.

I would like to take this opportunity to express gratitude to Ambassador Toni Frisch for his unwavering support and dedication as Chairman to the EMT Strategic Advisory Group.

On behalf of the EMT community, I would also like to thank our partners and donors who continue to keep the wheels of this Initiative in constant motion.

Finally, I would like to acknowledge our national medical team representatives who have journeyed from all over the globe to share their experiences at this meeting. Your contribution in highlighting best practices and ways of addressing challenges at the local level will continue to diversify and improve standards of care as we move forward. You are every bit the lifeblood of this Initiative.

Thank you to all partners of the EMT Initiative for joining us and I look forward to the continued collaboration with you as we take this important work forward together.

Dr Ian Norton

Manager, Emergency Medical Teams

World Health Organization



THANK YOU!

THE WHO EMT INITIATIVE WISHES TO THANK ALL GOVERNMENTS, INSTITUTIONS, AND ORGANIZATIONS WHO HAVE SUPPORTED THE EMT INITIATIVE IN EACH OF ITS STAGES, MOST ESPECIALLY

ROBERT KOCH INSTITUT



Department of Health, Department of Foreign Affairs and Trade, Northern Territory Australia



Special Administrative Region of Macao, China



European Union (DG ECHO)



Ministry of Foreign Affairs and Trade, New Zealand



Spanish Cooperation Agency for International Development



Swiss Agency for Development and Cooperation



emteams@who.int

[#EMTeams](#)